

E2 Assembly Instructions

Step 1:

Place encoder base onto mounting surface. Slip centering tool over the shaft and into the center hole of the base. While holding pressure on the centering tool, tighten mounting screws. Remove centering tool.

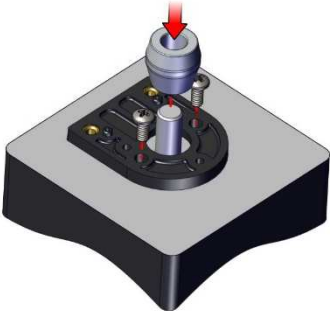

Step 2:

Place spacer tool around shaft. Slip hubdisk assembly onto shaft and slide down until it bottoms out against spacer tool.

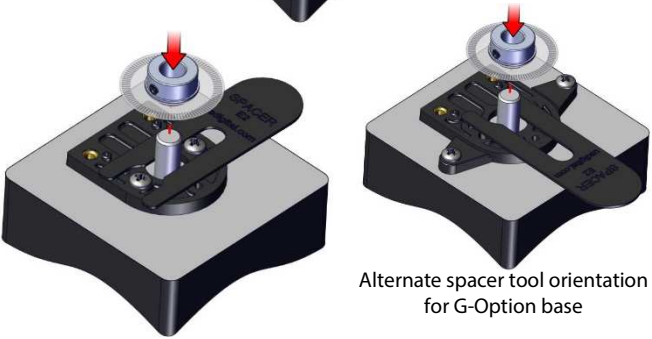

Note: Alternate spacer orientations may be required depending on the base/mounting configuration

Step 3:

Tighten set screw with provided hex wrench while pressing down on hub. Remove spacer tool.

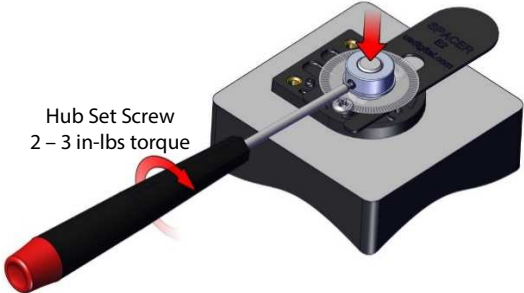

Hub Set Screw
2 – 3 in-lbs torque

Step 4:

Slip optical module into position so the two alignment pins slip into holes of module (thin side of module towards bottom).

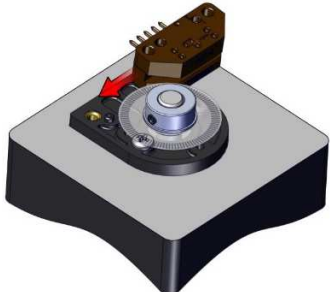

Step 5:

Place cover over assembly and secure with two 4-40 x 5/8" pan head screws (supplied).

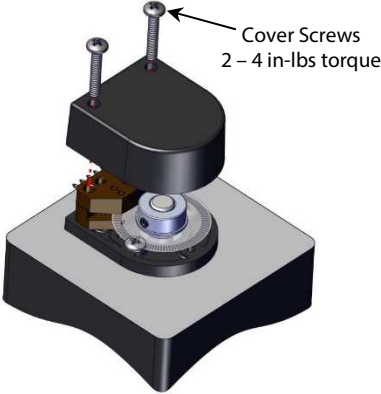

Cover Screws
2 – 4 in-lbs torque

