

E6 Optical Kit Encoder (Base and Cover Options)

RELEASE DATE: 07/24/2025

E-OPTION COVER  
(EXTENSION FOR SHAFT  
LENGTHS UP TO .750 [19.05])

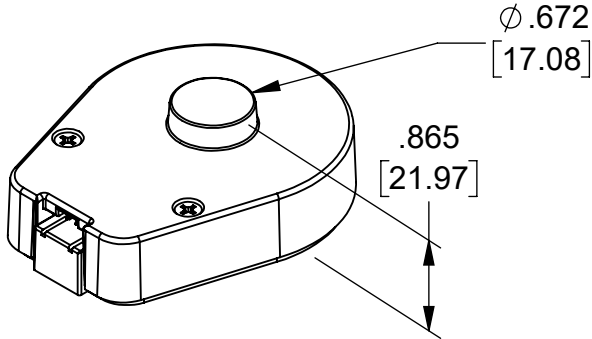

H-OPTION COVER  
(HOLE FOR SHAFT  
LENGTHS OVER .750 [19.05])

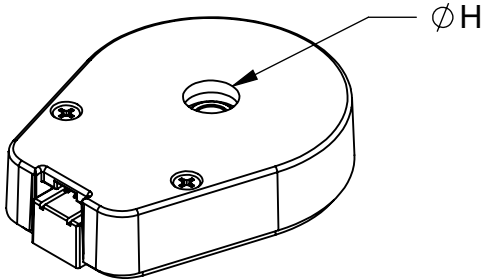

H=.438 [11.13] FOR SHAFT SIZES  $\leq \phi .394$  [10]  
H=1.047 [26.59] FOR SHAFT SIZES  $> \phi .394$  [10]

3-OPTION BASE  
(LARGER MOUNTING HOLES)

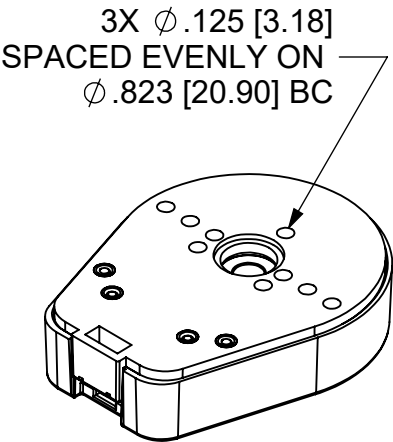

M-OPTION BASE  
(MOUNTING PLATE)  
REQUIRES MINIMUM .570 [14.48] SHAFT LENGTH

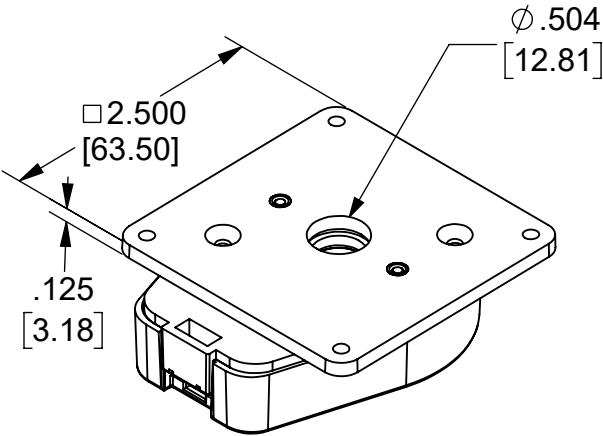

FOR SHAFTS  $\leq \phi .394$  [10]

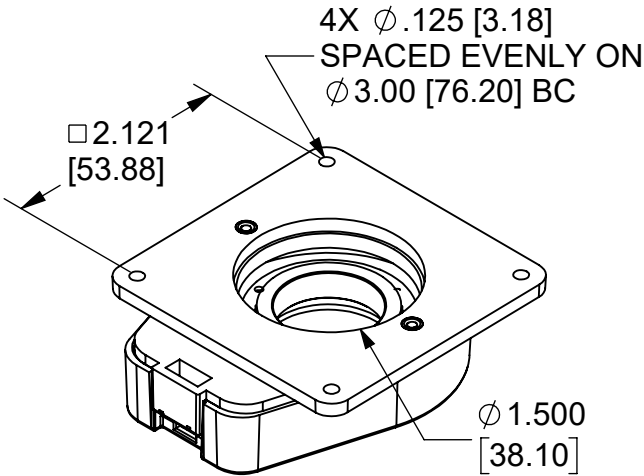

FOR SHAFTS  $> \phi .394$  [10]